

FOR SALE

1143-51 DELAWARE AVENUE

PHILADELPHIA, PA

DEVELOPMENT OPPORTUNITY AVAILABLE



APPROVED FOR 196 RESIDENTIAL UNITS AND COMMERCIAL SPACE

- | | |
|----------------------------|-----------------------------|
| ZONED: | • C-3 Commercial |
| SITE AREA: | • 1.49752 acres (65,232 SF) |
| # OF UNITS: | • 196 |
| ACCESSORY PARKING: | • 249 |
| COMMERCIAL SPACE: | • 2,230 SF |
| PROPOSED BLDG SIZE: | • 318,846 SF |
| HEIGHT OF GARAGE: | • 60' - 0" |
| HEIGHT OF TOWER: | • 445' - 0" |

Meets requirements for parking ratios, parking for the physically handicapped, loading, and for window set-backs. This scheme is envisioned as a unified tower and garage sheathed in semi-transparent glass skin.



FOR MORE
INFORMATION
PLEASE
CONTACT

Patrick Green
Executive Vice President
215.561.8940
www.cbre.com/patrick.green
patrick.green@cbre.com
Licensed: PA
Licensed Salesperson: NJ

Michael Mullen
Senior Associate
215.561.8927
www.cbre.com/michael.mullen
michael.mullen@cbre.com
Licensed: PA
Licensed Salesperson: NJ

CB Richard Ellis, Inc.
Two Liberty Place
50 S. 16th Street, Suite 3000
Philadelphia, PA 19102
T: 215.561.8900 | F: 215.557.6719
www.cbre.com/philadelphia
Licensed Real Estate Broker

© 2011 CB Richard Ellis, Inc. This information has been obtained from sources believed reliable. We have not verified it and make no guarantee, warranty or representation about it. Any projections, opinions, assumptions or estimates used are for example only and do not represent the current or future performance of the property. You and your advisors should conduct a careful, independent investigation of the property to determine to your satisfaction the suitability of the property for your needs.

CBRE
CB RICHARD ELLIS

FOR SALE

1143-51 DELAWARE AVENUE

PHILADELPHIA, PA

DEVELOPMENT OPPORTUNITY AVAILABLE

PROPOSED
DEVELOPMENT
SITE PLAN

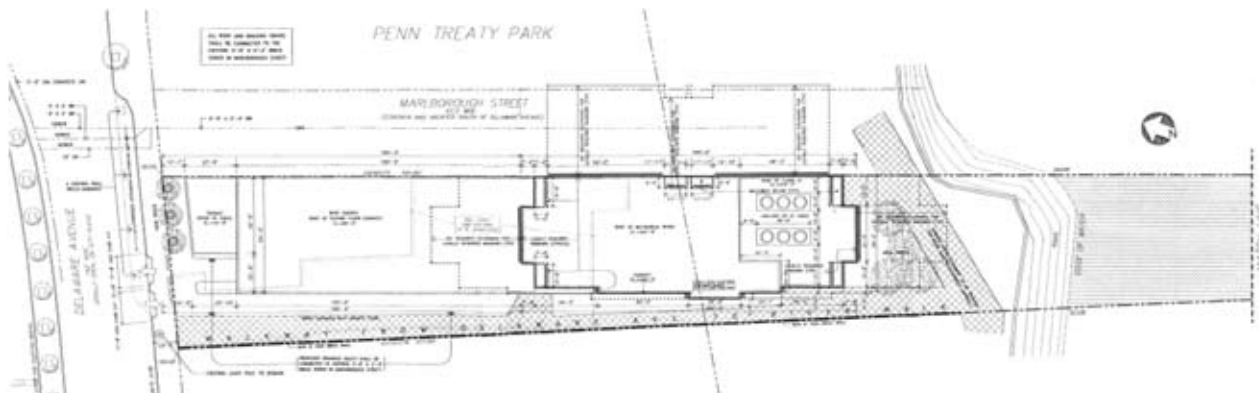

FOR MORE
INFORMATION
PLEASE
CONTACT

Patrick Green

Executive Vice President
215.561.8940
www.cbre.com/patrick.green
patrick.green@cbre.com
Licensed: PA
Licensed Salesperson: NJ

Michael Mullen

Senior Associate
215.561.8927
www.cbre.com/michael.mullen
michael.mullen@cbre.com
Licensed: PA
Licensed Salesperson: NJ

CB Richard Ellis, Inc.

Two Liberty Place
50 S. 16th Street, Suite 3000
Philadelphia, PA 19102
T: 215.561.8900 | F: 215.557.6719
www.cbre.com/philadelphia
Licensed Real Estate Broker

© 2011 CB Richard Ellis, Inc. This information has been obtained from sources believed reliable. We have not verified it and make no guarantee, warranty or representation about it. Any projections, opinions, assumptions or estimates used are for example only and do not represent the current or future performance of the property. You and your advisors should conduct a careful, independent investigation of the property to determine to your satisfaction the suitability of the property for your needs.

CBRE
CB RICHARD ELLIS